

Public Notice

Notice of Request to Amend Petition to Annex 921.34 Acres to the City of Palmer

The owner of a 1.5-acre parcel (tax parcel B-3, T17NR2E05) adjoining the 921.34-acre area proposed for annexation to the City of Palmer on April 25, 2002, has requested that the 1.5 acre parcel be annexed to the City of Palmer. The location of the referenced 1.5-acre parcel is shown below.

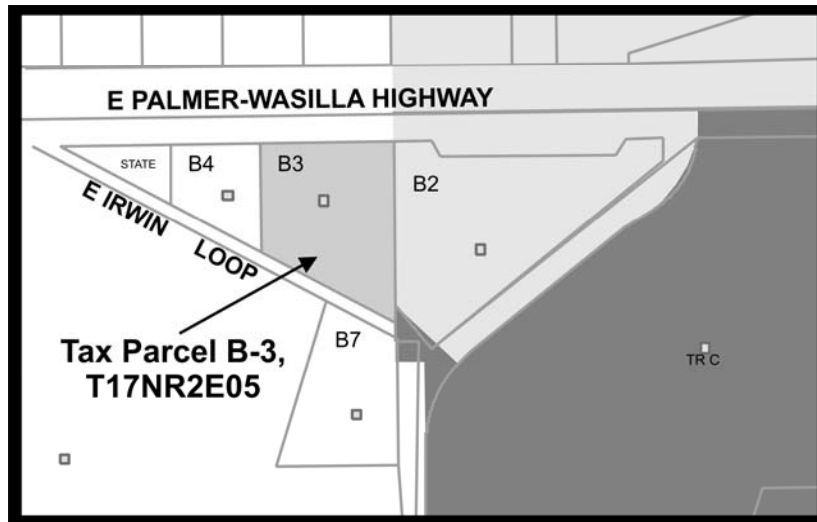

Questions concerning the proposal may also be directed to LBC staff in Anchorage at 269-4557, where a copy of the annexation petition and supporting materials is also available for public review.

The opportunity now exists for the filing of comments in support of or in opposition to annexation of the referenced 1.5 acre parcel to the City of Palmer. Comments must be received by **LBC Staff at 550 West 7th Avenue, Suite 1770, Anchorage, AK 99501-3510 (fax: 907-269-4539) not later than 5:00 p.m., November 15, 2002.**